

Projektinformation

Robot Lines

Empty crate storage on simple, flat floor



REWE
PRODUKTIONSBETRIEBE



**View of the storage area with
Portal Gantry Robot and Stacking Station**

W. Brandenburg is a traditional meat processing concern with operations across Germany. In recent years it has been a company in the Rewe group.

The issue of short-term buffering presents itself here like in many other fresh food processing plants as it illustrates a space-intensive logistic problem.

The Brandenburg company went a different way and palletised stacked, empty crates directly on the floor. In this way storage of different crate types is achieved with a very high stacking concentration which can be quickly filled and re-emptied. The production and order picking area now provides empty crates on demand against a works order.

Ro-ber's delivery scope consisted of portal gantry of a 35 x 8 m gantry portal robot with container stackers at the infeed to the robot line.

The system was installed under the project management of Flexlink in September 2004.

Line Layout

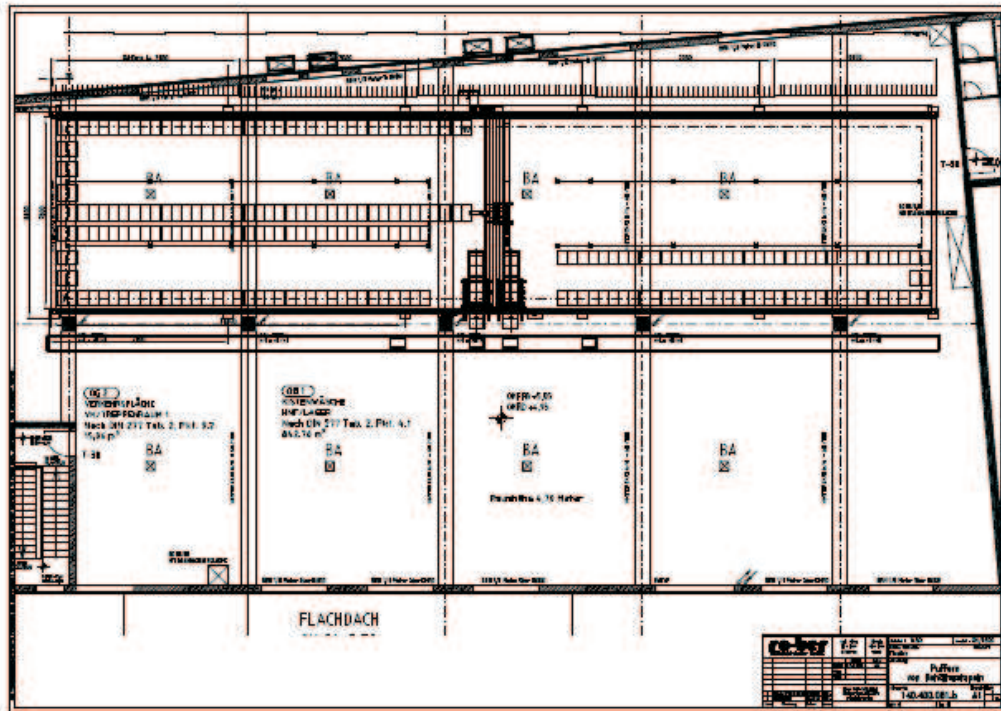

Project Data

Robot: Gantry Portal Robot FP100-4/ST

Size: 35 m x 8 m

Capacity: Robot: max. 3,100 Containers/h
Stacker: max. 1,080 Containers/h per unit

Container types: E1- and E2-Crates

Max. storage capacity: E1: 15,800 pieces
E2: 9,600 pieces

Gripper: Mechanical gripper for double stacking with a height up to 2.6 m

